

Dear customer,

Thank you for choosing **TASI**.

If there are any technical questions, please contact:

<http://www.china-tasi.com>

## Introduction

TA503 series is a digital tachometer that can measure the RPM or surface speed and distance. It is applicable to electric power, steel, petrochemical, aviation, fan manufacturing, pipeline ventilation system, underground warehouse and other occasions.

## Safety Information

To prevent eye damage and personal injury, please read all safety information carefully before you use the product.

### Warning

- Do not use this product in an environment with explosive gas, flammable vapor and dust;
- Please check the product before use. Do not use if the product is damaged;
- Replace the batteries when the "[ ]" symbol shows to prevent incorrect measurements;
- Under contact measurement model, it is easy to cause the measurement value to be lower than the normal value due to insufficient friction if the rotating speed of the measured object is too fast;

- During contact measurement, please keep the ambient light source stable, otherwise the measurement may fail;
- To prevent battery leakage, please remove the battery if the product is not used for an extended period of time, or if stored in temperatures above 50°C;
- Only authorized technicians are allowed to repair this product.

## Product

### Overview

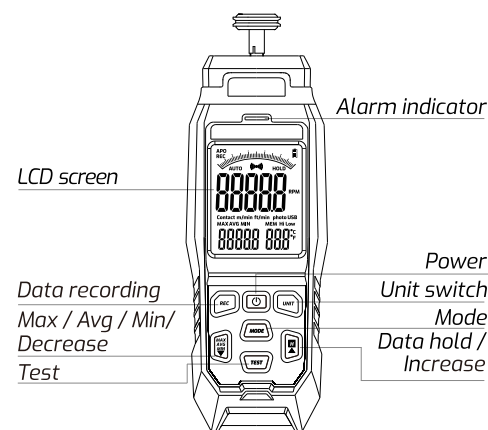

### Display

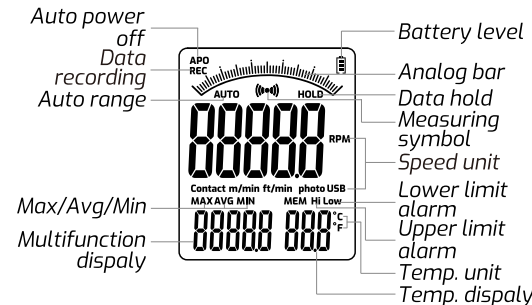

## Technical Specifications

Model	TA503A	TA503B	TA503C
Range	3 ~ 100000RPM	3 ~ 19999RPM 0 ~ 99999m 0 ~ 1999.9m/min 0 ~ 9999.9ft/min	Non-contact type: 3 ~ 100000RPM Contact type: 3 ~ 19999RPM 0 ~ 99999m 0 ~ 1999.9m/min 0 ~ 9999.9ft/min
Accuracy	±0.05%FS+1RPM	±0.1%FS+1RPM ±0.1%FS+0.2m ±0.1%FS+0.2m/min ±0.1%FS+0.6ft/min	Non-contact type: ±0.05%FS+1RPM Contact type: ±0.1%FS+1RPM
Resolution	RPM: <10000: 0.1 RPM: ≥10000: 1	RPM: <10000: 0.1 RPM: ≥10000: 1 m: <10000: 0.1 m: ≥10000 ≤100000: 1 m/min: <2000: 0.1 ft/min: <1000: 0.1	
Display		5 digits, max 99999	
Ambient temp.	Range	-10 ~ 50°C	
	Accuracy	±2°C	
Effective measuring distance		50mm ~ 500mm	
Sampling time		0.8s (above 60rpm)	
Data recording		2000 groups	
PC connection		—	√
Working environment		-10 ~ 50°C, max 80%RH, indoor altitude<2000m	
Storage environment		-10 ~ 50°C, max 70%RH (battery removed)	
Product size		185 x 70 x 35mm	200 x 70 x 35mm
Weight		Approx. 190g	Approx. 200g
		(battery not included)	
Power		3 x 1.5V AA(LR06) / USB micro interface 5V	

## Operation

### Probe Application

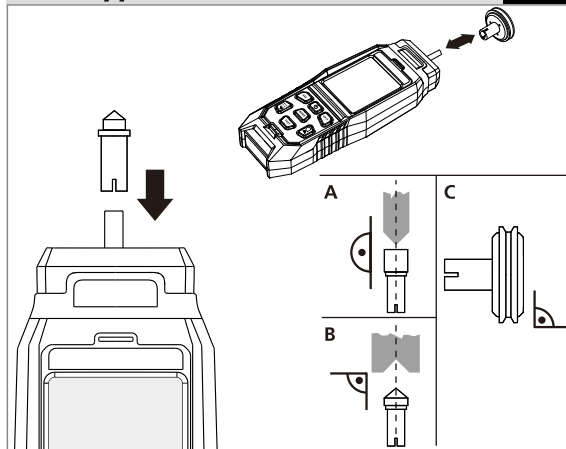

### Non-Contact Type

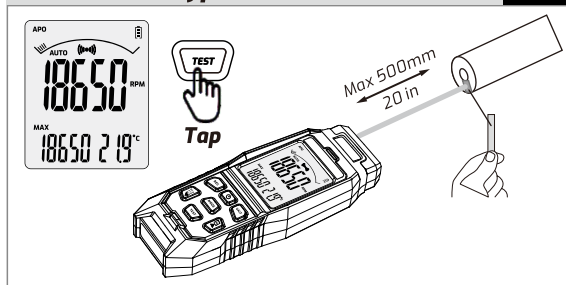

-5-

### Contact Type

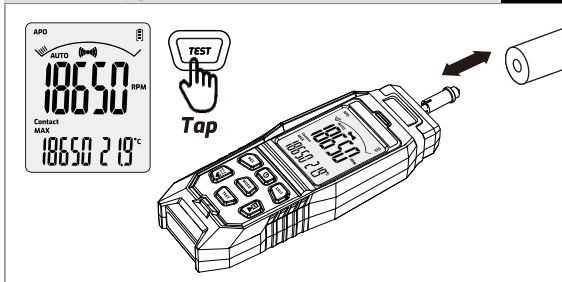

### Data Hold

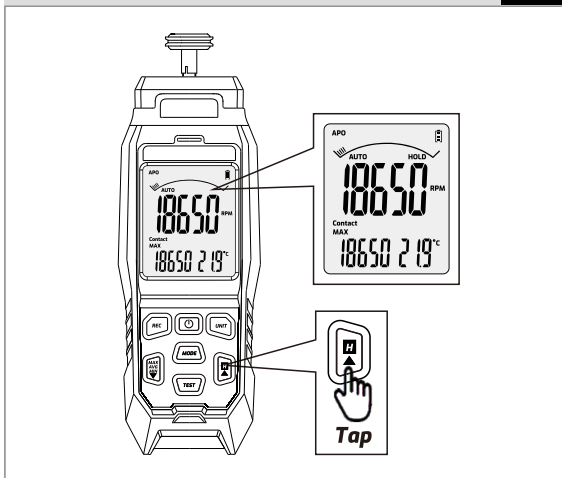

-6-

### °C & °F

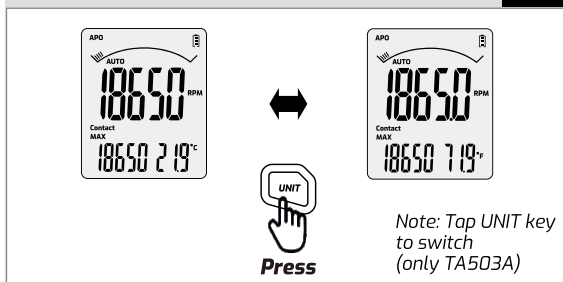

### Max / Min / Avg

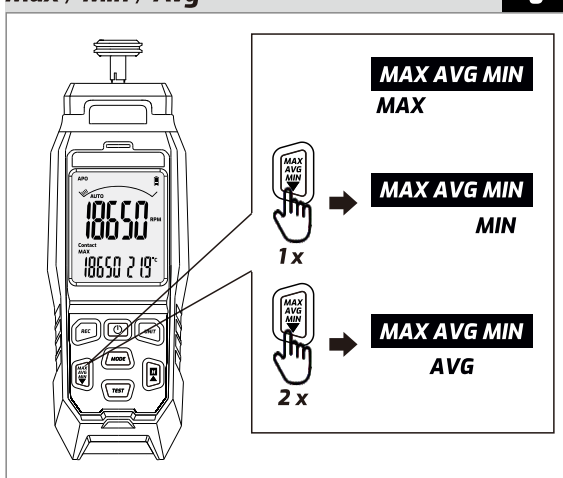

-7-

### Data Recording

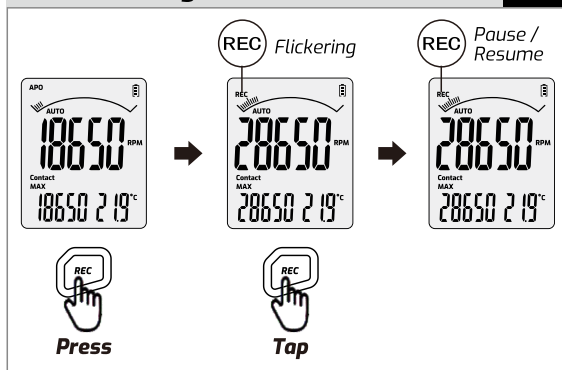

### High Alarm Value

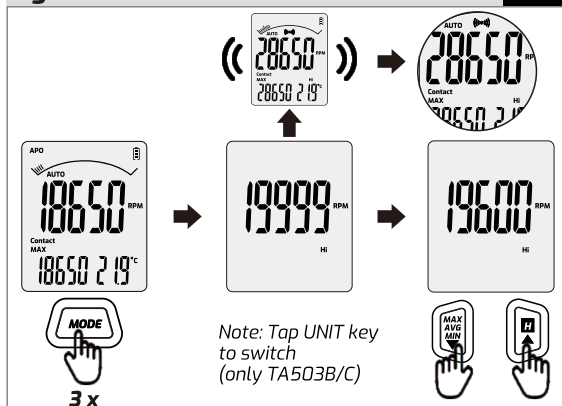

-8-

### Low Alarm Value

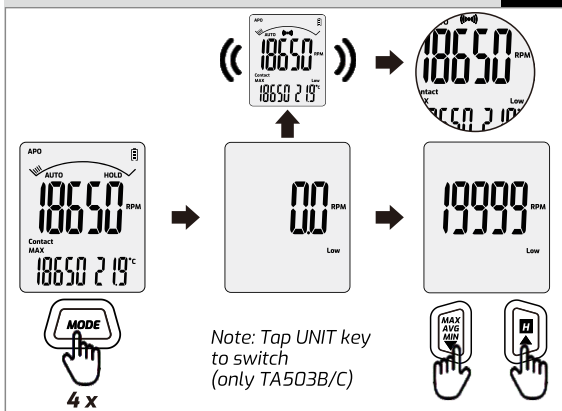

### Recording Interval Time Setting

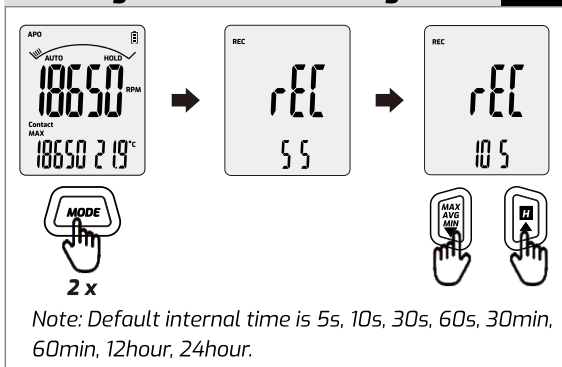

-9-

## Recording Data Check Setting 11

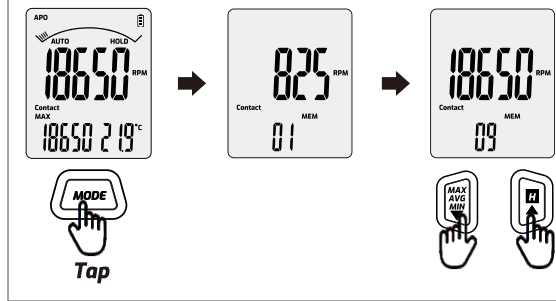

## Storage Data Clearing 12

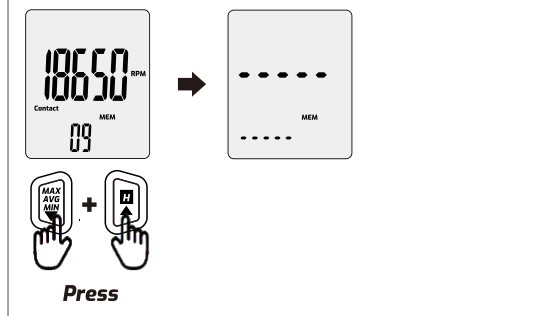

## Battery Replacement 13

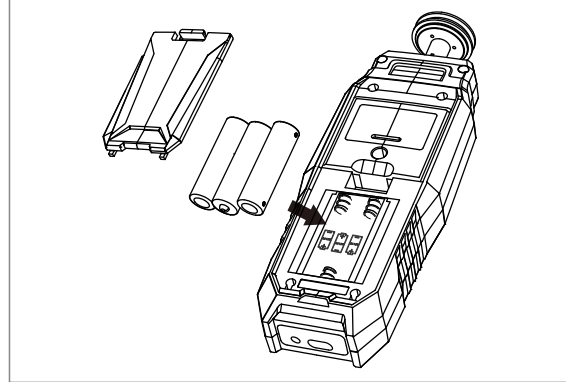

Please scan the QR code to download the driver software.  
(Only TA503C)



## Warranty:

Each product is warranted in material and workmanship under normal use. The warranty period is one year and begins on the date of purchase.

To obtain warranty service, please contact the dealer or manufacturer to obtain return authorization information, then send the product to the service center.

**TASI**



Product: DIGITAL TACHOMETER  
Model: TA503A / B / C  
Date: 16/02/2023

**Suzhou TASI Electronics Co.,Ltd.**

Add: 5th Floor, Building 5, No. 317, Mudong Road,  
Wuzhong District, Suzhou City, Jiangsu Province, China.  
Tel: +86-512-68057436  
<http://www.china-tasi.com>

**MADE IN CHINA**